

# TEMPLETON CRES, GIRRAWHEEN

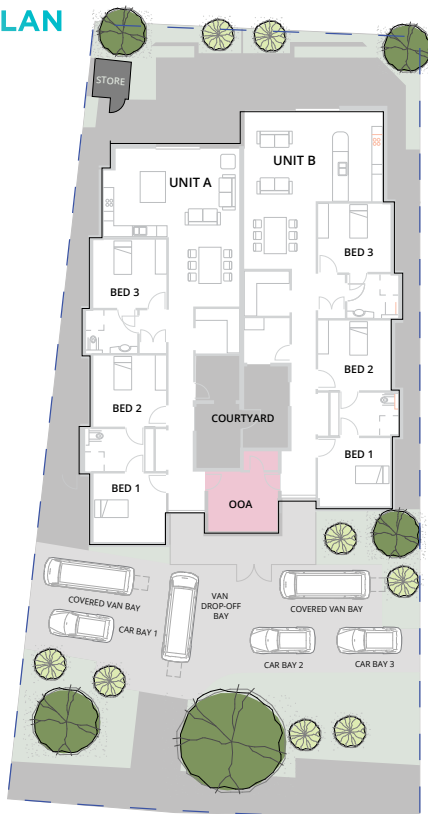

Artist impression

## SCHEMATIC SITE PLAN



**SHIFT**  
ACCESSIBLE HOMES

### AVAILABLE OPTIONS

 3  2  2 x 2

2 x 3 bedrooms, 2 x ensuites, 2 x parking  
Built to High Physical Support category



OPENING DOORS TO YOUR BEST LIFE

## HOME FEATURES

### STANDARD SDA FEATURES

- Safe, step-free accessways throughout
- Accessible car parking
- Air conditioning to living and bedroom areas
- Fire and acoustic separated bedrooms with fire sprinkler system throughout the home
- Spacious open plan living and accessible kitchen
- Continuous back-up power
- Provision for ceiling hoist in bedroom
- Provision for automated bedroom door
- On-site carer's room
- Automated keyless entry
- Smart lighting
- Accessible covered outdoor area and multiple landscaped garden areas

### ADDITIONAL SHIFT HOMES FEATURES

- Second private living area
- Automated blackout blinds
- Home security system linked to intercom
- Kitchen sink and cooktop on adjustable benchtop
- Separately controlled air conditioning to each bedroom with provision for automation
- Wide passages and doors sized above design standards (1050mm clear)
- Large bedrooms sized above design standards
- Private ensuite sized above design standards
- Accessible laundry with washing machine and dryer
- Large storage areas for personal items and equipment

### SAFETY

All SHIFT Accessible Homes adhere to Class 3 Residential Care Building standards, ensuring rigorous compliance with safety regulations.

- Fire alarm and sprinkler system
- Direct connection of alarm to Fire Brigade for immediate response
- Continuous power backup for operation of doors and safety equipment

### ADDITIONAL SAFETY FEATURES

In addition to the mandatory safety measures, SHIFT Accessible Homes are equipped with supplementary features to enhance security and comfort:

- Intercom entry system linked to a monitor in the house
- CCTV security to external areas
- Automated keyless front and rear doors for secure entry
- Fully integrated home automation system for convenient operation of lighting, window blinds, and other features



SHIFT  
ACCESSIBLE HOMES

A Rocky Bay company



Rocky Bay  
HEALTH + COMMUNITY



SDA Provider Number  
4050074073

(08) 6399 4100

shifthomes.org.au